



Chheda Electricals & Electronics Pvt.Ltd.,

Product Category: **DIU (Combined Digital CDI & Ignition Coil)**

Specially Designed for delivering good reliability manufactured in a strict QS9000 environment.



Models	OEM Part No	Product Photo	CEEPL PART CODE
TVS STAR	N8060140		2100
	N8060180	<p data-bbox="573 1031 954 1121">N8060140 = N8060180 without earth wire</p> 	

SPECIFICATIONS

GENERAL ELECTRICAL SPECIFICATIONS:

- 1] WITHSTAND VOLTAGE : 30kV min.
- 2] OPERATING AMBIENT TEMP. RANGE : -10°C TO +70°C
- 3] OPEN CIRCUIT VOLTAGE : 14 kV MIN. @ 500~10000 RPM, 50 kV MAX.
- 4] SPARK DURATION : 140 μs MIN. @ 2000 RPM.
- 5] CABLE PULL OUT STRENGTH : 10 kgf min. @ Coil end as well suppressor cap end
- 6] TERMINAL PULL OUT STRENGTH : 7 kgf min.
- 7] CUT-IN RPM : 350rpm max @ 6mm spark gap
- 8] IGNITION TIMING @ 1500rpm. : Ref Timing curve.
- 9] THE UNIT SHALL PASS EMI TEST AS PER AIS004 WITH ASSOCIATED PARTS.
- 10] CONDENSER CAPACITY (FOR IGNITION): 2.2μF/400V.
- 11] PULSER COIL AIR GAP: 0.7±0.1mm.
- 12] INDICATES SIGNIFICANT DIMENSIONS.
- 13] UNIT SHALL PASS ALL THE TESTS MENTIONED IN TSES 362
- 14] 100% BURN-IN FOR 1 HOUR WITH PEAK LOAD AT ROOM TEMPERATURE.
- 15] THE UNIT SHALL NOT FAIL/CAUSE FAILURE DUE TO EMI/EMC (FOR 1000 OPERATING HOURS)

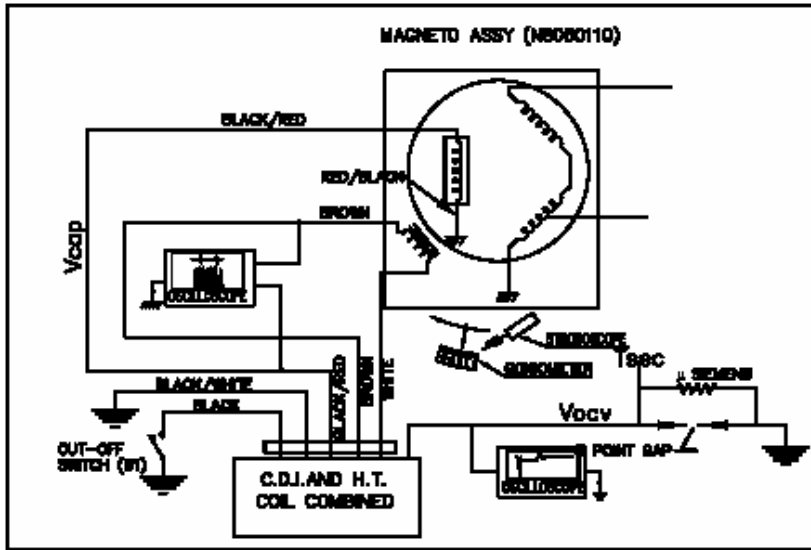

SET UP FOR PERFORMANCE TESTS.

PERFORMANCE GRAPHS

TIMING ADVANCE CURVE

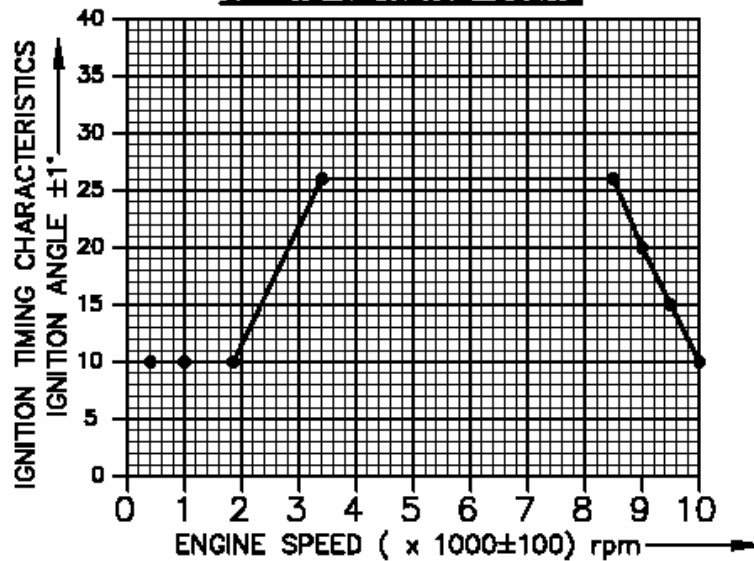

DIMENSIONS

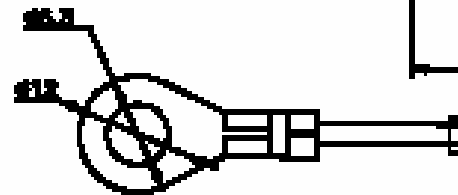
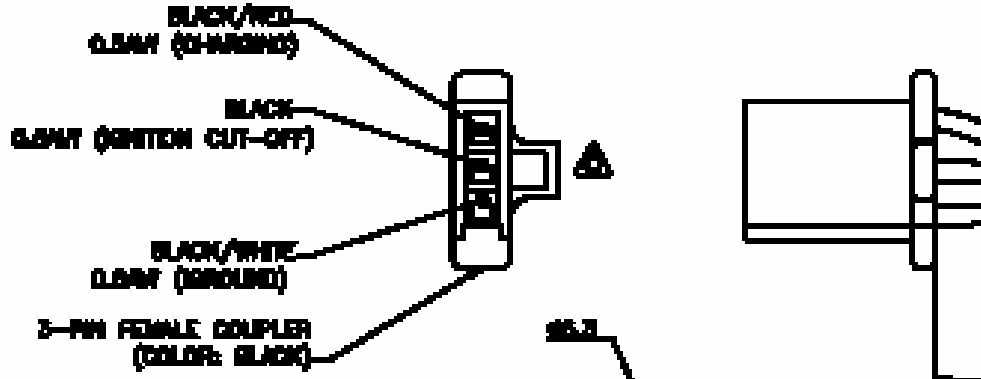
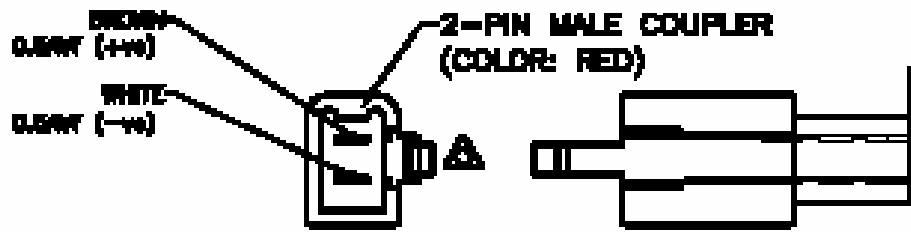

**EYELET LA106
BLACK/WHITE
(0.75Awf) WITH PVC
SLEEVE
LENGTH=350+10**

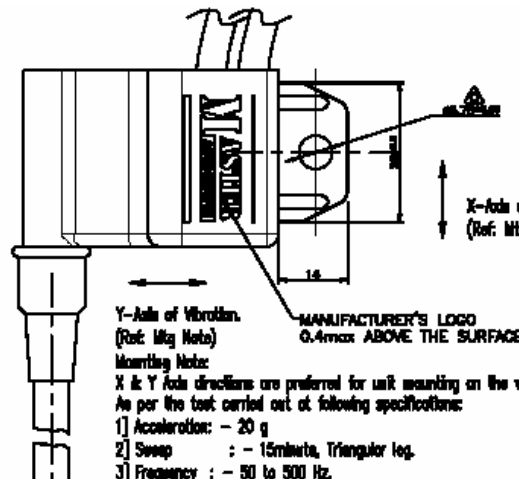
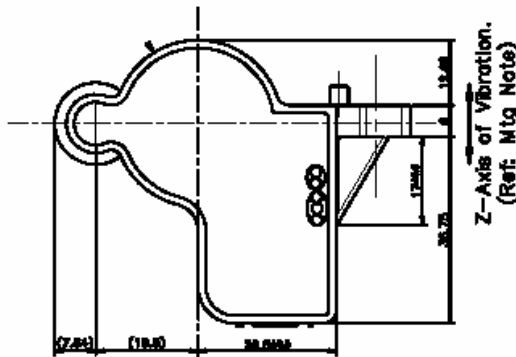

CONTACT

Chheda Electricals & Electronics Pvt.Ltd.,
14, Hadapsar Industrial Estate, Pune 411013, INDIA .
Ph : +91 20 26817780, 26876950 ; Fax : +91 20 26876948
Email : ignition@vsnl.com
Website : www.masterignition.com